

DIGITAL THERMOMETER

WARNING



Don't be auto diagnosis and treatment according to result of body temperature, consult your doctor, auto diagnosis may cause the worsening of your illness.



This product is used to your oxter, mouth and rectum
Please don't use to other places(E ear ETC.)
Otherwise unable to get correct body temperature, even hurt your ear ETC.



Please place it to untouch for children , don't use it alone by children , otherwise it will be hurted to your children after use.

ATTENTION



PT-P11A, PT-P11B AND PT-P11A(IPX7 device) is water proof.



Please don't unweave, repair, or reform without authorization.
Otherwise the measured value may cause error or breakdown..



Please don't bite this product , otherwise cause to occurrence and damage



Please put battery , screw to untouch place for children , please go to doctor if children accidently swallowed it.



Please wash with plenty of water in case the liquid from battery into your eyes, you must go to doctor for treatment, otherwise you may loss your sight ETC. disability.



Please don't throw the battery into the fire , otherwise the battery will be broken.



Please don't use it at the place of strong static electricity or electromagnetic wave , otherwise the measured value may cause error or breakdown



METHOD OF CORRECT MEASUREMENT

The measured value may be got incorrect if not proper operation when you use it.

WHEN MEASURE AT OXTER

1. Attach to the middle of oxter

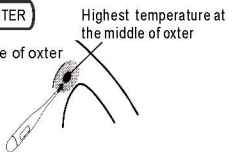

2. Boost up slightly, then clamp it, in order to full touch between thermometer and body, pleas hold the arm lightly.

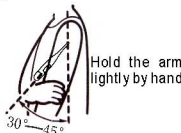
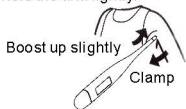

WRONG MEASUREMENT METHOD AS FOLLOWS

Thermometer is not in proper place



Thermal is easy to be out



WHEN MEASURE IN MOUTH

1. Attach to the right/left of tongue's root

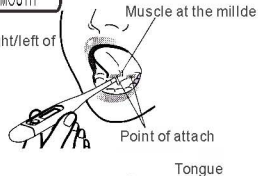

2. To coarctate the thermal of thermometer by tongue

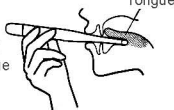

3. Carry it by hand to avoid the movement of thermometer, don't open your mouth during measurement.



WHEN MEASURE AT RECTUM

This is most accurate way to measure, and specially for baby and KID. Please insert the thermal 2-3cm deep to rectum

THE FOLLOWING SITUATIONS WILL NOT BE GOT CORRECT TEMPERATURE

1. Just finished the sports , bathing, or eating.
2. In the quilt very long time, sweat in the oxter.
3. Exercise after getting up.

USAGE METHOD

1. Press "power" button , after the beep, the screen is shown as right FIG.



2. Thermometer displays the temperature last time.



3. When it is ready to measure, put thermometer in correct place after "°C" flashed



4. When basically the temperature is no variation , "°C" stopped flashing, and buzzer makes a sound, remind you to confirm the result of measurement

★ Please keep the thermometer as long as possible to get accurate temperature

5. Press "power" button again , switch off.

★ Thermometer is self-closing after 10 min.
In order to get accurate temperature
2min at outer 80 seconds in the mouth
60 seconds in rectum

METHOD FOR BATTERY REPLACEMENT

If the screen is shown as right FIG. Please replace the battery.



Flashing

Method

1. Open battery cover
2. Push battery out by small bar as per arrow shown below

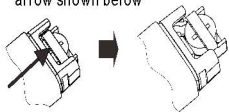
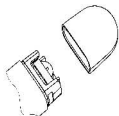

3. Push battery in the direction of arrow, + positive face up

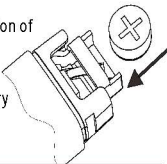

★ Battery: alkaline button battery
LR 41

CLEANSING AND DISINFECTING

The best way to clean the thermometer is by applying a disinfectant (e.g. 70% ethy alcohol) with a damp cloth.

DIAGNOSIS AND TREATMENT

DIAGNOSIS

Unstable value

No any display electrodes in screen when press power button

CHECK POINT

If you change the place to measure each time

If wrong electrodes when installing

If run out of battery

TREATMENT

Ref. to "method of correct measurement"

Please install correct

Please charge new battery (LR41)

TECHNICAL SPECIFICATIONS

Any change of improvement for specifications or overall will be not notice

NAME	Digital thermometer	MEASURING RANGE	35.5°C-42.0°C
BATTERY	DC 1.5V TYPE-LR41	MAX ERROR	0.1°C
RESOLUTION	0.1	WORKING CONDITIONS	10°C-35°C ≤80%RH
STORAGE CONDITIONS	-25°C-55°C ≤85%RH		

DISPOSAL PROCEDURE(DIR.2002/96/EC-WEEE)



The symbol on the bottom of the device indicates the separated collection of electric and electronic equipment. At the end of life of the device, do not dispose it as mixed solid municipal waste, but dispose it referring to a specific collection centre located in

Your area or returning it to the distributor, when buying a new device of the same type to be used with the same functions. This procedure of separated collection of electric and electronic devices is carried out forecasting a European environmental policy aiming at safeguarding, protecting and improving environmental quality, as well as avoiding potential effects on human health due to the presence of hazardous substances in such equipment or to an improper use of the same or of parts of the same.

Caution! The wrong disposal of electric and electronic equipment may involve sanctions.

WARRANTY

This appliance is warranted for a period of 3 years from the date of purchase as shown by the dealer's stamp and signature and by the purchaser's receipt for tax purposes which must be kept attached to this warranty. The warranty covers only any faults in manufacturing and does not cover accidental damage, incorrect use, negligence or misuse of the product. Use only the accessories provided; the use of accessories other than the approved ones can make your warranty void. Never open the appliance; in the event of any opening or tampering the warranty will automatically become invalid. The warranty does not cover either the parts subject to wear and tear or the batteries (if provided). The warranty expires 3 years from the date of purchase; after this period any technical service shall be changed.